



**4th October 2021**

**ADDENDUM ONE TENDER NO: EACC/13/2020-2021, ON PROCUREMENT OF PROPOSED PARTITIONING AND REFURBISHMENT OF EACC, 1<sup>ST</sup> FLOOR MADISON HOUSE PHASE 1, UPPERHILL, NAIROBI COUNTY**

Reference is made to the above open tender

Kindly find the below Bill of Quantities for Electrical works and drawing that were not included in the tender document.

The closing date for the above referenced tender remains at 8<sup>th</sup> February 2021 at 10.00 am

All other parameters and Pre-tender conference remain the same as stated in the tender document.

For further enquiries and Communication use the below communication channel.

[supply-chain@integrity.go.ke](mailto:supply-chain@integrity.go.ke)

Phone: 0709781000

0730997000

**PARTITIONING AND REFURBISHMENT OF EACC OFFICES ON FIRST FLOOR  
MADISON HOUSE, PHASE 1**

**SCHEDULE I: ELECTRICAL INSTALLATION WORKS**

Item	Description	Qty	Unit	Rate (Ksh)	Amount (Ksh)
1.00	<b>Supply, install, test and commission the following :-</b>				
	<b>LIGHTING POINTS</b>				
1.01	Lighting points comprising of 3 x 1.5mm SC, PVC insulated CU cables drawn in concealed HG PVC conduits for:-				
	a) One way switching	39	No.		
	b) Two way switching	16	No.		
	<b>SWITCHES</b>				
1.02	10A Architrave switch plates as Clipsal/MK/Crabtree as follows;				
	a) One gang one way	10	No.		
	b) One gang two way	4	No.		
	<b>LIGHTING FITTINGS</b>				
1.03	Lighting fittings complete with lamps of appropriate wattage and colour rendering as follows:-				
	a) 40W Standard Surface mounted 600 X 600 LED coolday Panel Light complete with slim housing, as PHILLIPS or an equal and approved equivalent.	24	No.		
	b) 40W Standard Recessed 600 X 600 LED coolday Panel Light, as PHILLIPS or an equal and approved equivalent.	16	No.		
	c) Standard circular splashproof surface luminaire with polycarbonate body and white trim, polycarbonate opal diffuser and integral control gear for 28 W 2D compact LED lamp as THORN Superclub or approved equivalent.	9	No.		
	d) 12W Circular recessed LED panel downlight as PHILIPS or an equal and approved equivalent	6	No.		
<b>SUB TOTAL C/F TO NEXT PAGE</b>					

SCHEDULE 1 CONT'D					
Item	Description	Qty	Unit	Rate (Ksh)	Amount (Ksh)
	<b>Supply, install, test and commission the following :-</b>				
	<b>SUBTOTAL B/F FROM PREVIOUS PAGE</b>				
	<b>SOCKET OUTLETS AND OTHER POWER POINTS</b>				
1.04	3x2.5 mm sq. SC PVC CU cables wired in ring circuit drawn in 25mm diameter concealed HG PVC conduits/Trunking for sockets outlet	26	No.		
1.05	13A Twin socket plates as Clipsal/MK/Crabtree as follows;				
	a) Twin	26	No.		
1.06	a) Dp switch point wired in 3x4mm sq. SC PVC CU cables drawn in concealed 25mm phase HG PVC conduits for Air Conditioner	3	No.		
	b) 20A double pole switches with neon light ON indicator as Clipsal/MK/Crabtree for items above	3	No.		
1.07	a) Dp switch point wired in 3x4mm sq. SC PVC CU cables drawn in concealed 25mm phase HG PVC conduits for Hand drier	2	No.		
	b) 20A double pole switches with neon light ON indicator as Clipsal/MK/Crabtree for items above	2	No.		
1.08	(a) TV outlet point wired in 75 Ohms Screened Coaxial TV cables drawn in concealed 20mm diameter HG/PVC conduits and linked to the outside through the roof space via telephone draw in boxes.	1	Item		
	b) TV outlet plate with polished brass finish as MK, Clipsal, Crabtree or approved equivalent.	1	No.		
1.09	a) Dual Data/Telephone outlet point done in 20mm Dia. HG PVC conduits concealed in building fabric/ trunking complete with all necessary accessories	25	No		
	b) White moulded case dual data/telephone outlet plate as MK, Crabtree or approved equivalent.	25	No		
1.10	a) 200x50mm, two compartment cream powder coated metallic trunking complete with bends and fixing accessories for mounting sockets and data/voice outlets	50	LM		
	b) Mini trunking complete with bends and fixing accessories for surface mounted lighting fittings	20	LM		
1.11	Knockouts for mounting socket and data/voice face plates as follows				
	a) Twin	50	No.		
	<b>SUB TOTAL C/F TO SUMMARY PAGE</b>				

**SCHEDULE II: STRUCTURED CABLING**

Item	Description	Qty	Unit	Rate (Ksh)	Amount (Ksh)
<b>A</b>	<b>Horizontal Cabling</b>				
i)	Dual RJ45 cat 6A UTP Data/Telephone outlets complete with faceplates and labelling system as Siemons/Teldor or its equal and approved equivalent	25	No.		
ii)	1m, RJ45- RJ45 cat 6A UTP factory terminated patch cord as Teldor/Siemons to be used in cabinet.	25	No.		
iii)	3m, RJ45- RJ45 cat 6A UTP 4-pair factory terminated patch cord as Teldor/Siemons between cabinet and Outlet plates	25	No		
iv)	Four pair UTP (CAT 6A) cable drawn in the trunkings to wire both the data and voice points as Siemon or approved equivalent	1000	LM		
<b>B</b>	<b>Cabinets</b>				
i)	22U Wall/ground Mounted cabinet with low noise (low Db) fans and power outlet sockets.	1	No.		
ii)	24 port Data /Voice Patch panel as Teldor/Siemon.	2	No.		
iv)	Cable Manager	3	No.		
<b>SUB TOTAL C/F TO SUMMARY PAGE</b>					

**SUMMARY PAGE**

Item	Description	Qty	Unit	Rate (Ksh)	Amount (Ksh)
1	SUB-TOTAL FOR ELECTRICAL INSTALLATION WORKS				
2	SUB-TOTAL FOR STRUCTURED CABLING WORKS				
	<b>TOTAL FOR ELECTRICAL WORKS</b>				

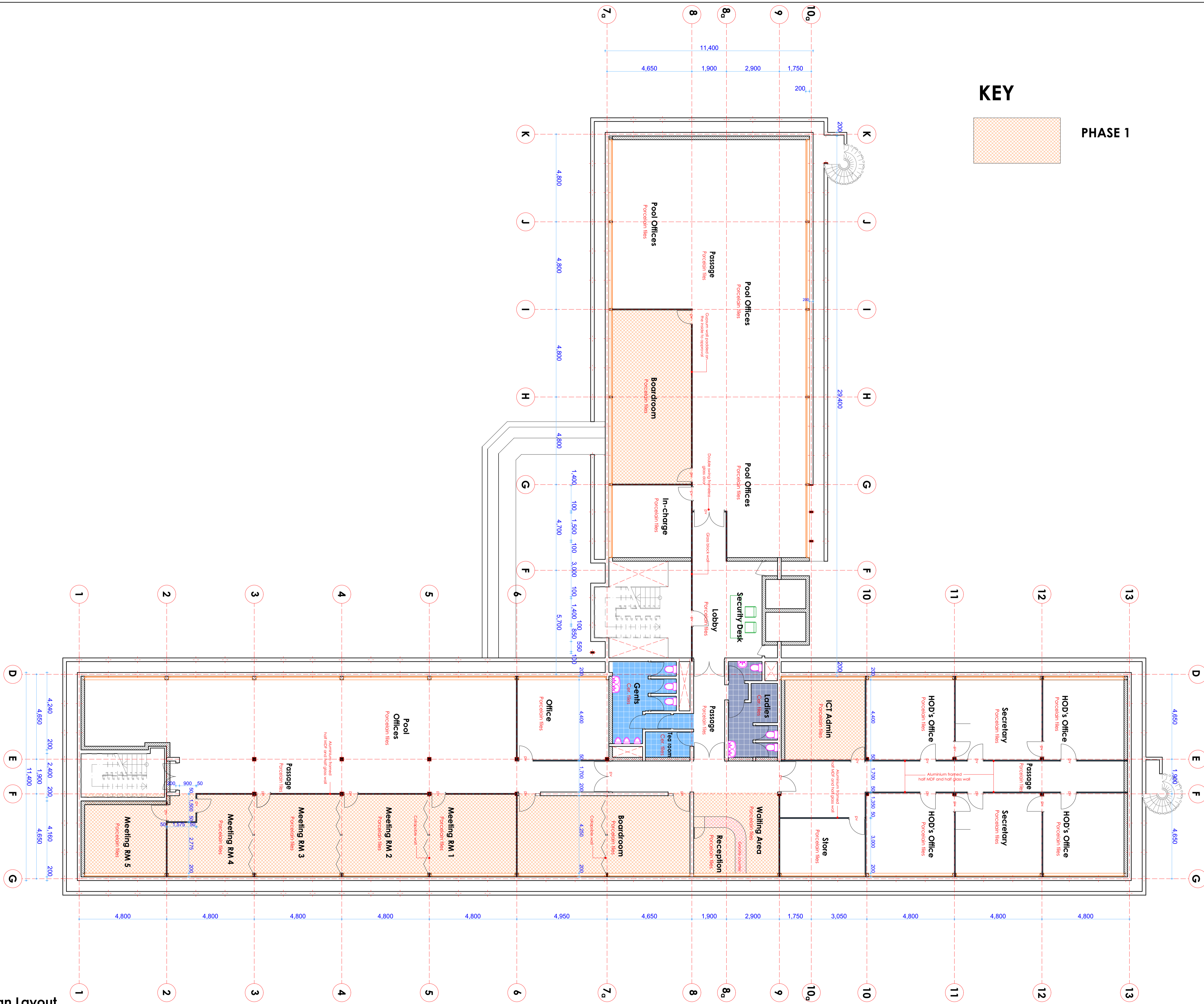

### KEY

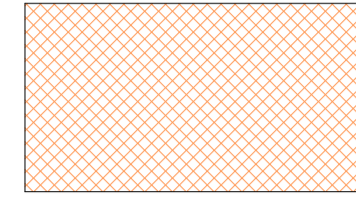

PHASE 1

### NOTES

**General**  
 This drawing is to be read in conjunction with engineers' drawings. All dimensions are in mm unless otherwise specified. Drawings are not to be scaled. Only figured dimensions to be used. The contractor must check & verify all the dimensions before commencement of the work.

**Construction**  
 All slabs of ground level to be laid over 1000 gauge polythene sheeting on 20mm thick masonry blinding on well compacted hardcore. All slabs under slabs & ground external foundation to be poised for the termite control.

**Structural**  
 All black cotton soil to be removed from below of building & paved surfaces. All paved surfaces to be clear of black cotton soil to a distance of 500m outside the edge of the surface.  
 For all R.C. works, refer to SE3 details.  
 Foundation depths to be determined on site to the SE approval. All walls less than 200mm thick to be reinforced with hoop iron of every alternate course.  
 All adjacent R.C. work and masonry walls to be tied with strap irons at every course.

**Mechanical**  
 All plumbing & drainage work to comply with P.H specifications. All surface ducts to be accessible from all floors.  
 S.P. denotes soil vent pipe and to be provided at the head of the drainage. Drains passing beneath buildings and driveways to be enclosed in 150mm concrete surround. All underground foul & waste drain pipes shall be of PVC, to comply with BS5255. All inspection chambers covers and framing shall be cast iron to comply with BS-477 Table 1 Grade A.  
 The storm water drain pipes to comply with BS. 556. Minimum slope in the drain pipes to be 1%.  
 No changes for pipes will be allowed in the slabs. Sieves will be allowed with written approval from the SE.  
 No cutting of concrete without express approval of the Architect or SE. All testing of pipes must be coordinated with electrical & any conflicts must be clarified before works begins.  
 P.V denotes permanent vents.

**Electrical**  
 All conduits must be laid before plastering.

**Fire fighting**  
 Provide a 1130 litres reserve tank with a booster pump Dry riser.  
 Provide a 1x20m hydraulic hose reel, on every floor.  
 Provide manual electric break glass fire alarm system.  
 Provide 490kg litres water CO2 fire extinguishers on every floor.

**Revisions**

No.	Description

**Project:**  
 PROPOSED REFURBISHMENT AT MADISON HOUSE PHASE 1

**Drawing Title**  
 PHASE 1 FLOOR PLAN:

**Folio no.:**

**Client ministry/Department:**  
 ETHICS & ANTI-CORRUPTION COMMISSION (EACC)

**client signature** \_\_\_\_\_  
**code**

**scale**

1	
2	
3	

**Project Job no.** \_\_\_\_\_ **Drawing no.** \_\_\_\_\_

name	signed	date
Drawn & Designed by T.M		Dec 2019
Proj. Arch Arch. Wanjala		Dec 2019
Team leader Arch. Kafuna		Dec 2019

**Approved:**  
 Architect S. K. Muli OGW

**Chief Architect:** \_\_\_\_\_

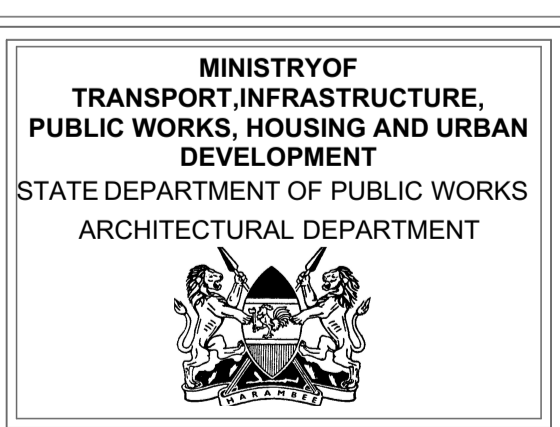

FOR THE GOVERNMENT OF THE REPUBLIC OF KENYA

Floor Plan Layout